



FEY-15R3-K

Parts List:

Fender Eliminator

2015 Yamaha YZF-R3

- Fender Eliminator Bracket 1
- 6 x 20 mm Allen Bolts 4

<<<<<< IT IS RECOMMENDED THAT THIS PRODUCT BE INSTALLED BY A QUALIFIED TECHNICIAN >>>>>>

- 1) Remove the passenger seat.
- 2) Remove the two 5mm allen head bolts holding down the center plastic cover between the two seats. Then you will be able to remove the cover. **Photo 1.**



Photo 1

- 3) Remove the two 8mm head bolts holding down the front seat, then remove the seat.
- 4) Remove the storage tray by releasing the two Phillips head rivets located on the sides of the storage tray.
- 5) Locate and unplug the three plugs coming out of the stock fender.
- 6) Remove the air deflector wing by removing the 4 phillips head rivets under the rear fender.
- 7) To remove the lower fender support and wire cover, you will need to remove the four phillips head screws and six 4mm allen head bolts. **Photo 2.**

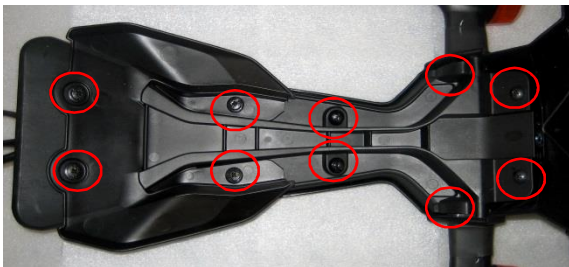

Photo 2

- 8) Remove the four 10mm head lock nuts from the rear fender assembly. Be sure to hold the fender to prevent it from falling once the nuts are removed. **Photo 3**

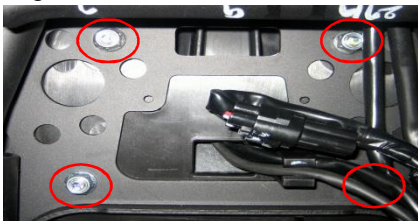

Photo 3

- 9) The Graves fender eliminator is set up with turn signal mounts attached which will accommodate the stock turn signals.

* Moving the turn signal mounts to the outermost hole position will allow the use of the Graves flush mount marker lights. (Graves Part Number TS401C1)

** If you are using a taillight integrated kit you can remove the turn signal brackets.

- 10) If using the stock turn signals, remove them from the rear fender by removing the 2 plastic signal retainers at the mounting point of the signals. Carefully remove the signals from their mounting holes.
- 11) Re-install the stock signals in the reverse sequence.
- 12) After the turn signals have been installed, feed the turn signal wires through the center hole of the Graves fender eliminator bracket.
- 13) Using the supplied button head allen bolts, install the fender eliminator bracket to the motorcycle. Secure with the stock 10mm head lock nuts.
- 14) In the reverse sequence, plug in the turn signals, re-install the center plastic cover and the seats.

