



AB011: Smog Block Off Plates

FITMENT:

Yamaha . R1(04-16) / R6(03-14) / R6S(06-09) / FZ1/6/8(all years)/FZ10(2016)
Kawasaki . ZX6R(03-08) / ZX6RR(04-06) / ZX10R(all years) / ZX12(04-05)
ZX14R(all years)



PARTS LIST:

- Smog Block Off Plate 2
- Airbox Cap 1

<<<<< IT IS RECOMMENDED THAT THIS PRODUCT BE INSTALLED BY A QUALIFIED TECHNICIAN >>>>>

- 1) Remove the left and right lower and mid fairings.
- 2) Remove the air intake scoops.
- 3) Remove the left side bolt and lower bolt holding the radiator in place.
- 4) Slide the radiator off its mount on the right side of the bike. The bolt does not need to be removed.
- 5) Look behind the radiator and disconnect the electrical plug going to the smog pump.
- 6) Remove the hose clamps from the smog pump. Remove the smog pump.
- 7) Once the smog pump is removed you will have room to get to the bolts holding the smog port covers on.
- 8) Use a short 5mm Allen wrench to remove the bolts from the smog port covers. The bolts have loctite and will be very tight.
- 9) Apply blue loctite to the stock bolts and install the smog block off plates.
- 10) Remove the fuel tank and airbox. Remove the hose from the left side of the airbox and cover the outlet with the included cap. Be sure to secure the cap with a zip tie or safety wire.
- 11) Reinstall the airbox
- 12) Reinstall the fuel tank
- 13) Reinstall the radiator
- 14) Reinstall the air intake scoops
- 15) Reinstall the fairings

NOTE: Using a shortened 5mm ball end Allen wrench or a short stubby socket will be the easiest way to remove the bolts.

The bolts are long with plenty of thread, take your time to remove them.

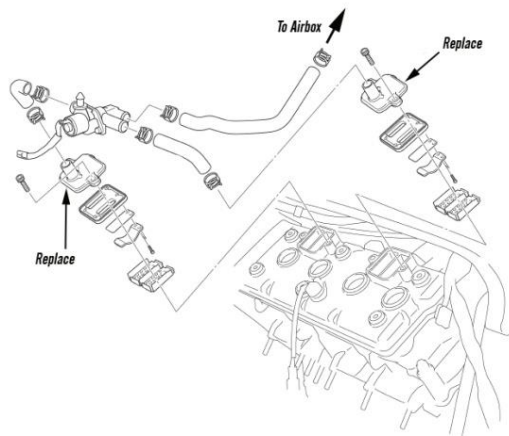

The purchaser releases Graves Motorsports, Inc. from all liabilities pertaining to the installation and use of purchased parts. Purchaser recognizes that any alteration and/or modifications to the vehicle may increase the risk of injury or accident. **This product is intended for Closed Course Competition Use Only** and may render the vehicle illegal for use on public roads.